

Transition Neff to Early Childhood Center

ON NOVEMBER 6, 2018, THE GRAND LEDGE COMMUNITY WILL VOTE ON TWO BOND PROPOSALS.

Proposal One would provide \$118,640,000 for district-wide building and grounds improvements that would address identified and ongoing building issues and would support the district's grade restructuring initiative. Proposal Two would provide \$29,485,000 for athletic and fine arts building and grounds improvements for district and community use.

What Is The District's Grade Restructuring Initiative?

If Proposal One is approved, the grade restructuring made possible by the bond proposal would have many positive effects. Creating K-4th grade elementary schools would mean fewer students in buildings. Kindergarteners would start at their neighborhood elementary school, likely the same one where older siblings attend, and not have to transition elsewhere after their first year. Creating a 5th-6th grade intermediate school would provide flexibility in grouping students for instruction and afford an opportunity for broader curriculum offerings, possibly creating advanced classes along with band and choir. Students would begin to transition away from self-contained, elementary methods of instruction to more departmentalized, secondary-school methods. Transitioning Beagle to a middle school for all 7th-8th grade students would create a secondary school campus with proximity to the high school. Both middle school and high school students could take advantage of the broader curriculum offerings and student services.

Improvements at Neff would provide necessary upgrades to the 63 year old building and would be included in the first phase of work.

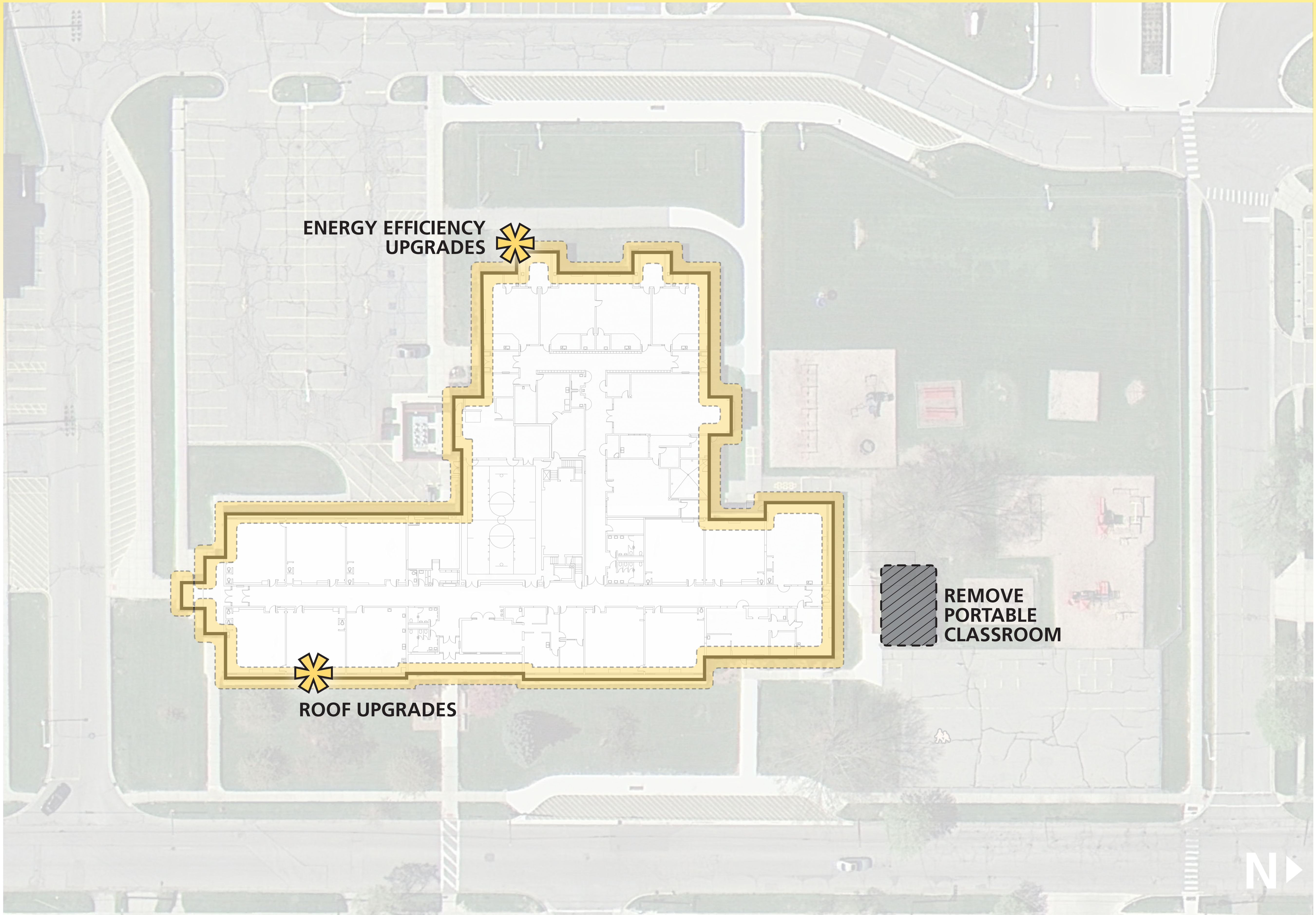

Create **SMARTER** Schools

- Proposal One was developed to create **SMARTER** schools by providing modern learning environments and supporting the district grade restructuring initiative:
- Upgrading student and staff devices
 - Updating technology infrastructure, including classroom multimedia upgrades, to maximize connectivity, access, and learning

Create **STRONGER** Schools

- Proposal One was developed to create **STRONGER** schools by investing in infrastructure to support district grade restructuring:
- Upgrading mechanical and electrical systems to increase operational efficiencies
 - Replacing roofing, windows, and other exterior materials as needed

Create **SAFER** Schools

- Proposal One was developed to create **SAFER** schools by upgrading safety measures:
- Updating exterior lighting

Conceptual site and building diagrams depict potential building and site relationships. Actual layout and design to be determined by school community and staff.



Transition to Delta Center Elementary for Grades K-4

ON NOVEMBER 6, 2018, THE GRAND LEDGE COMMUNITY WILL VOTE ON TWO BOND PROPOSALS.

Proposal One would provide \$118,640,000 for district-wide building and grounds improvements that would address identified and ongoing building issues and would support the district's grade restructuring initiative. Proposal Two would provide \$29,485,000 for athletic and fine arts building and grounds improvements for district and community use.

What Is The District's Grade Restructuring Initiative?

If Proposal One is approved, the grade restructuring made possible by the bond proposal would have many positive effects. Creating K-4th grade elementary schools would mean fewer students in buildings. Kindergarteners would start at their neighborhood elementary school, likely the same one where older siblings attend, and not have to transition elsewhere after their first year. Creating a 5th-6th grade intermediate school would provide flexibility in grouping students for instruction and afford an opportunity for broader curriculum offerings, possibly creating advanced classes along with band and choir. Students would begin to transition away from self-contained, elementary methods of instruction to more departmentalized, secondary-school methods. Transitioning Beagle to a middle school for all 7th-8th grade students would create a secondary school campus with proximity to the high school. Both middle school and high school students could take advantage of the broader curriculum offerings and student services.

Improvements at Delta Center would support the district-wide restructuring plan by providing age-appropriate spaces for grades K-4 and would provide necessary upgrades to the 59 year old building. Improvements at Delta Center would be included in the second phase of work.

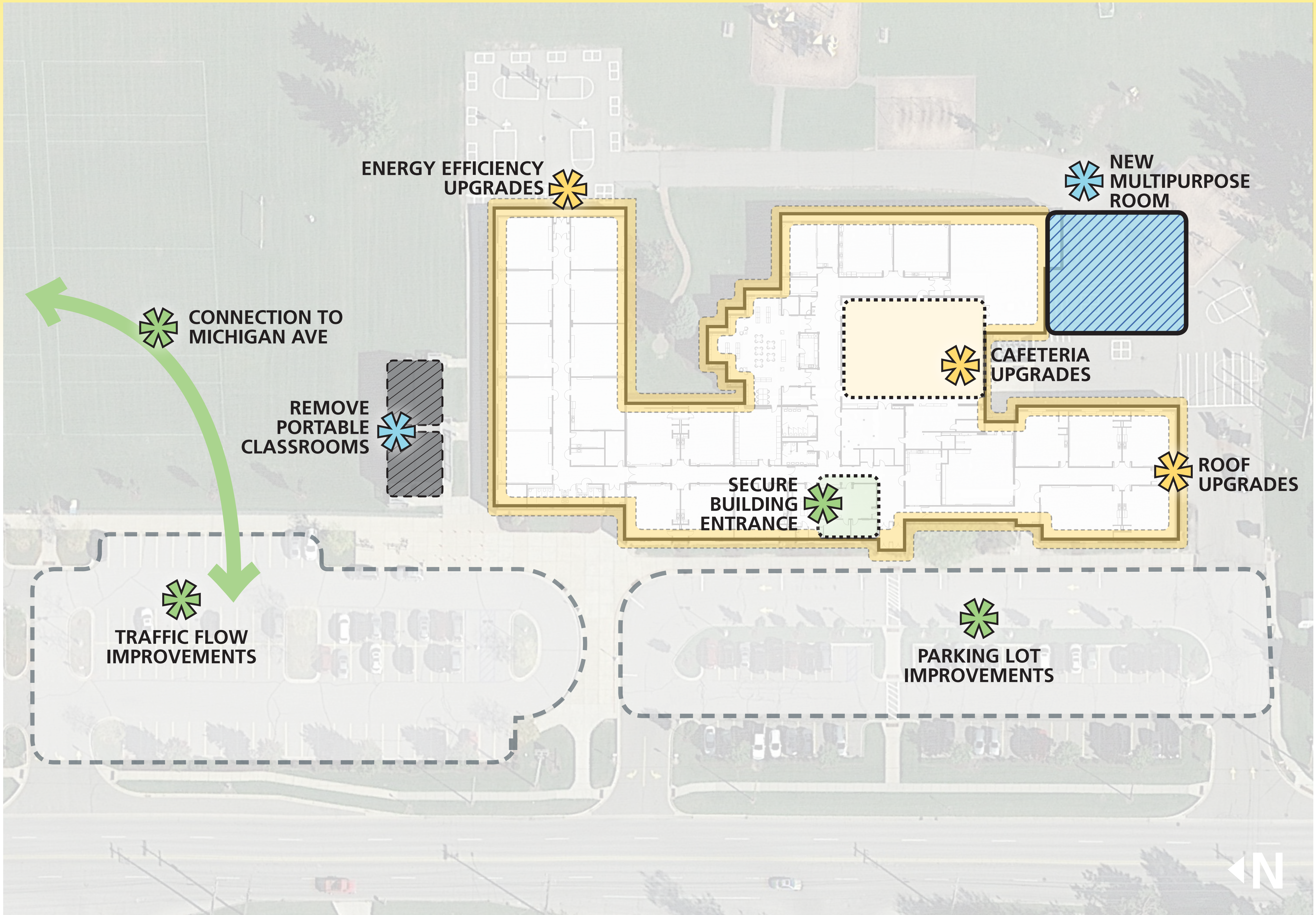

Create **SMARTER** Schools

- Proposal One was developed to create **SMARTER** schools by providing modern learning environments and supporting the district grade restructuring initiative:
- Performing upgrades and renovations to create modern classrooms, including flexible furniture, LED lighting, and integrated technology
 - Upgrading student and staff devices
 - Adding a multipurpose room
 - Updating technology infrastructure, including classroom multimedia upgrades, to maximize connectivity, access, and learning

Create **STRONGER** Schools

- Proposal One was developed to create **STRONGER** schools by investing in infrastructure to support district grade restructuring:
- Funding critical upgrades to the mechanical, electrical, and plumbing systems to increase operational efficiencies
 - Replacing interior finishes as needed
 - Renovating the cafeteria

Create **SAFER** Schools

- Proposal One was developed to create **SAFER** schools by upgrading safety measures:
- Providing a secure building entrance and adding video surveillance
 - Updating exterior lighting
 - Improving traffic flow at drop-offs and pick-ups for pedestrian safety, and improving parking lots and paving

Conceptual site and building diagrams depict potential building and site relationships. Actual layout and design to be determined by school community and staff.



Transition to Holbrook Elementary for Grades K-4

ON NOVEMBER 6, 2018, THE GRAND LEDGE COMMUNITY WILL VOTE ON TWO BOND PROPOSALS.

Proposal One would provide \$118,640,000 for district-wide building and grounds improvements that would address identified and ongoing building issues and would support the district's grade restructuring initiative. Proposal Two would provide \$29,485,000 for athletic and fine arts building and grounds improvements for district and community use.

What Is The District's Grade Restructuring Initiative?

If Proposal One is approved, the grade restructuring made possible by the bond proposal would have many positive effects. Creating K-4th grade elementary schools would mean fewer students in buildings. Kindergarteners would start at their neighborhood elementary school, likely the same one where older siblings attend, and not have to transition elsewhere after their first year. Creating a 5th-6th grade intermediate school would provide flexibility in grouping students for instruction and afford an opportunity for broader curriculum offerings, possibly creating advanced classes along with band and choir. Students would begin to transition away from self-contained, elementary methods of instruction to more departmentalized, secondary-school methods. Transitioning Beagle to a middle school for all 7th-8th grade students would create a secondary school campus with proximity to the high school. Both middle school and high school students could take advantage of the broader curriculum offerings and student services.

Improvements at Holbrook would support the district-wide restructuring plan by providing age-appropriate spaces for grades K-4 and would provide necessary upgrades to the 63 year old building. Improvements at Holbrook would be included in the first phase of work.

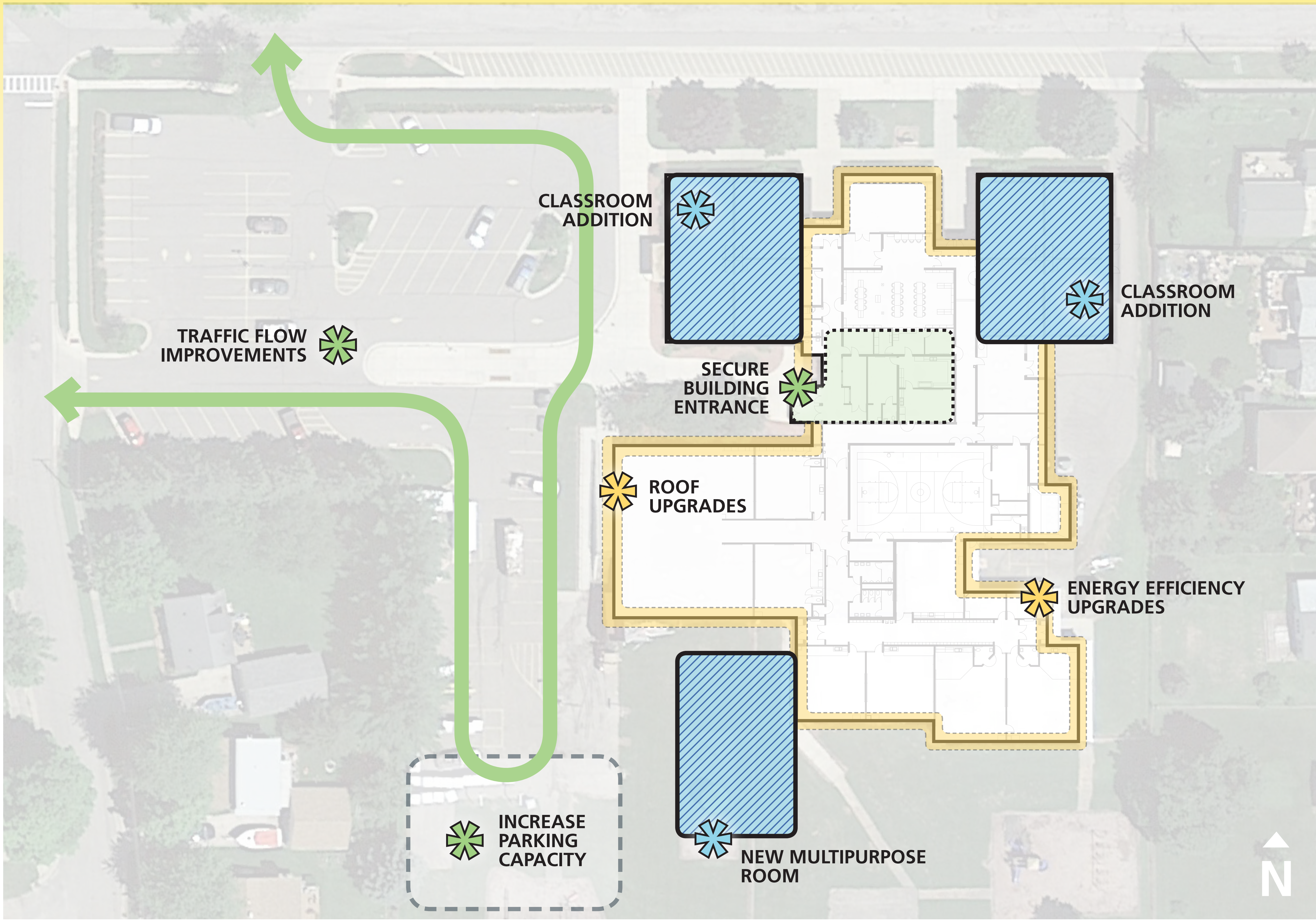

Create **SMARTER** Schools

- Proposal One was developed to create **SMARTER** schools by providing modern learning environments and supporting the district grade restructuring initiative:
- Adding 16 classrooms to Holbrook to support district restructuring
 - Performing upgrades and renovations to create modern classrooms, including flexible furniture, LED lighting, and integrated technology
 - Upgrading student and staff devices
 - Adding a multipurpose room
 - Updating technology infrastructure, including classroom multimedia upgrades, to maximize connectivity, access, and learning

Create **STRONGER** Schools

- Proposal One was developed to create **STRONGER** schools by investing in infrastructure to support district grade restructuring:
- Funding critical upgrades to the mechanical, electrical, and plumbing systems to increase operational efficiencies
 - Replacing roofing as needed
 - Replacing interior finishes as needed

Create **SAFER** Schools

- Proposal One was developed to create **SAFER** schools by upgrading safety measures:
- Providing a secure building entrance and adding video surveillance
 - Updating exterior lighting
 - Improving traffic flow at drop-offs and pick-ups for pedestrian safety, and improving parking lots and paving

Conceptual site and building diagrams depict potential building and site relationships. Actual layout and design to be determined by school community and staff.



Transition to Wacousta Elementary for Grades K-4

ON NOVEMBER 6, 2018, THE GRAND LEDGE COMMUNITY WILL VOTE ON TWO BOND PROPOSALS.

Proposal One would provide \$118,640,000 for district-wide building and grounds improvements that would address identified and ongoing building issues and would support the district's grade restructuring initiative. Proposal Two would provide \$29,485,000 for athletic and fine arts building and grounds improvements for district and community use.

What is The District's Grade Restructuring Initiative?

If Proposal One is approved, the grade restructuring made possible by the bond proposal would have many positive effects. Creating K-4th grade elementary schools would mean fewer students in buildings. Kindergarteners would start at their neighborhood elementary school, likely the same one where older siblings attend, and not have to transition elsewhere after their first year. Creating a 5th-6th grade intermediate school would provide flexibility in grouping students for instruction and afford an opportunity for broader curriculum offerings, possibly creating advanced classes along with band and choir. Students would begin to transition away from self-contained, elementary methods of instruction to more departmentalized, secondary-school methods. Transitioning Beagle to a middle school for all 7th-8th grade students would create a secondary school campus with proximity to the high school. Both middle school and high school students could take advantage of the broader curriculum offerings and student services.

Rebuilding Wacousta on the same site would support the district-wide restructuring plan by providing age-appropriate spaces for grades K-4 and would replace the aged and inefficient building. Construction at Wacousta would be included in the second phase of work.

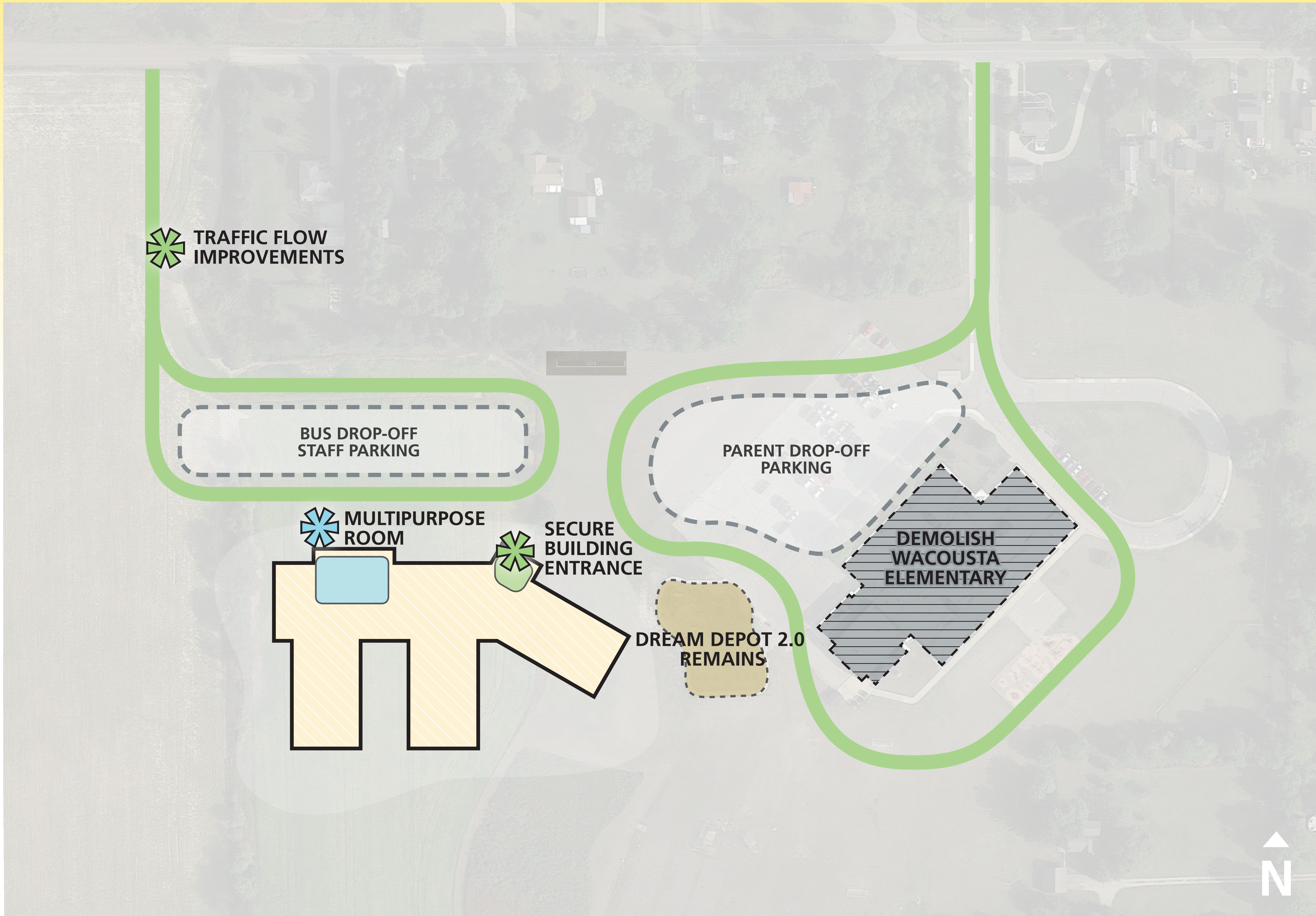

Proposal One was developed to create **SMARTER** schools by providing modern learning environments and supporting the district grade restructuring initiative:

- Creating modern classrooms, including flexible furniture, LED lighting, and integrated technology
- Upgrading student and staff devices
- Building a multipurpose room
- Providing technology infrastructure, including classroom multimedia, to maximize connectivity, access, and learning



Proposal One was developed to create **STRONGER** schools by investing in infrastructure to support district grade restructuring:

- Installing up-to-date mechanical, electrical, and plumbing systems to increase operational efficiencies



Proposal One was developed to create **SAFER** schools by upgrading safety measures:

- Providing a secure building entrance and video surveillance
- Installing exterior lighting
- Designing proper traffic flow at drop-offs and pick-ups for pedestrian safety

Conceptual site and building diagrams depict potential building and site relationships. Actual layout and design to be determined by school community and staff.



Transition to Willow Ridge Elementary for Grades K-4

ON NOVEMBER 6, 2018, THE GRAND LEDGE COMMUNITY WILL VOTE ON TWO BOND PROPOSALS.

Proposal One would provide \$118,640,000 for district-wide building and grounds improvements that would address identified and ongoing building issues and would support the district's grade restructuring initiative. Proposal Two would provide \$29,485,000 for athletic and fine arts building and grounds improvements for district and community use.

What Is The District's Grade Restructuring Initiative?

If Proposal One is approved, the grade restructuring made possible by the bond proposal would have many positive effects. Creating K-4th grade elementary schools would mean fewer students in buildings. Kindergarteners would start at their neighborhood elementary school, likely the same one where older siblings attend, and not have to transition elsewhere after their first year. Creating a 5th-6th grade intermediate school would provide flexibility in grouping students for instruction and afford an opportunity for broader curriculum offerings, possibly creating advanced classes along with band and choir. Students would begin to transition away from self-contained, elementary methods of instruction to more departmentalized, secondary-school methods. Transitioning Beagle to a middle school for all 7th-8th grade students would create a secondary school campus with proximity to the high school. Both middle school and high school students could take advantage of the broader curriculum offerings and student services.

Improvements at Willow Ridge would support the district-wide restructuring plan by providing age-appropriate spaces for grades K-4 and would provide necessary upgrades to the 22 year old building. Improvements at Willow Ridge would be included in the third phase of work.

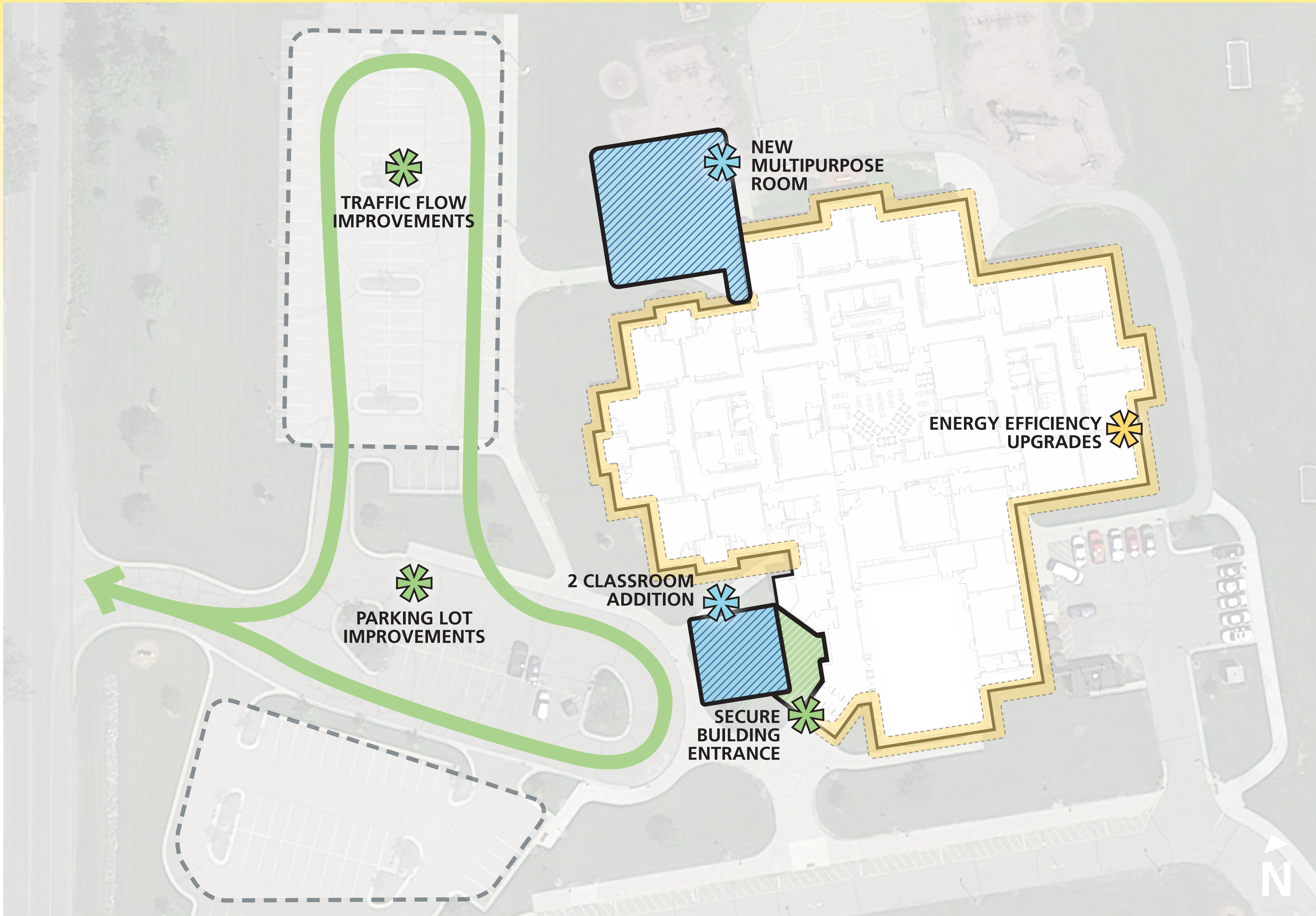

Conceptual site and building diagrams depict potential building and site relationships. Actual layout and design to be determined by school community and staff.



- Proposal One was developed to create **SMARTER** schools by providing modern learning environments and supporting the district grade restructuring initiative:
- Adding 2 classrooms to Willow Ridge to support district restructuring
 - Performing upgrades and renovations to create modern classrooms, including flexible furniture, LED lighting, and integrated technology
 - Upgrading student and staff devices
 - Adding a multipurpose room
 - Updating technology infrastructure, including classroom multimedia upgrades, to maximize connectivity, access, and learning



- Proposal One was developed to create **STRONGER** schools by investing in infrastructure to support district grade restructuring:
- Funding critical upgrades to the mechanical, electrical, and plumbing systems to increase operational efficiencies
 - Replacing roofing as needed
 - Replacing interior finishes as needed



- Proposal One was developed to create **SAFER** schools by upgrading safety measures:
- Providing a secure building entrance and adding video surveillance
 - Updating exterior lighting
 - Improving traffic flow at drop-offs and pick-ups for pedestrian safety, and improving parking lots and paving



Transition to Hayes Intermediate School for Grades 5-6

ON NOVEMBER 6, 2018, THE GRAND LEDGE COMMUNITY WILL VOTE ON TWO BOND PROPOSALS.

Proposal One would provide \$118,640,000 for district-wide building and grounds improvements that would address identified and ongoing building issues and would support the district's grade restructuring initiative. Proposal Two would provide \$29,485,000 for athletic and fine arts building and grounds improvements for district and community use.

What Is The District's Grade Restructuring Initiative?

If Proposal One is approved, the grade restructuring made possible by the bond proposal would have many positive effects. Creating K-4th grade elementary schools would mean fewer students in buildings. Kindergarteners would start at their neighborhood elementary school, likely the same one where older siblings attend, and not have to transition elsewhere after their first year. Creating a 5th-6th grade intermediate school would provide flexibility in grouping students for instruction and afford an opportunity for broader curriculum offerings, possibly creating advanced classes along with band and choir. Students would begin to transition away from self-contained, elementary methods of instruction to more departmentalized, secondary-school methods. Transitioning Beagle to a middle school for all 7th-8th grade students would create a secondary school campus with proximity to the high school. Both middle school and high school students could take advantage of the broader curriculum offerings and student services.

Improvements at Hayes would support the district-wide restructuring plan by providing age-appropriate spaces for grades 5-6 and would provide necessary upgrades to the 51 year old building. Improvements at Hayes would be included in the third phase of work.

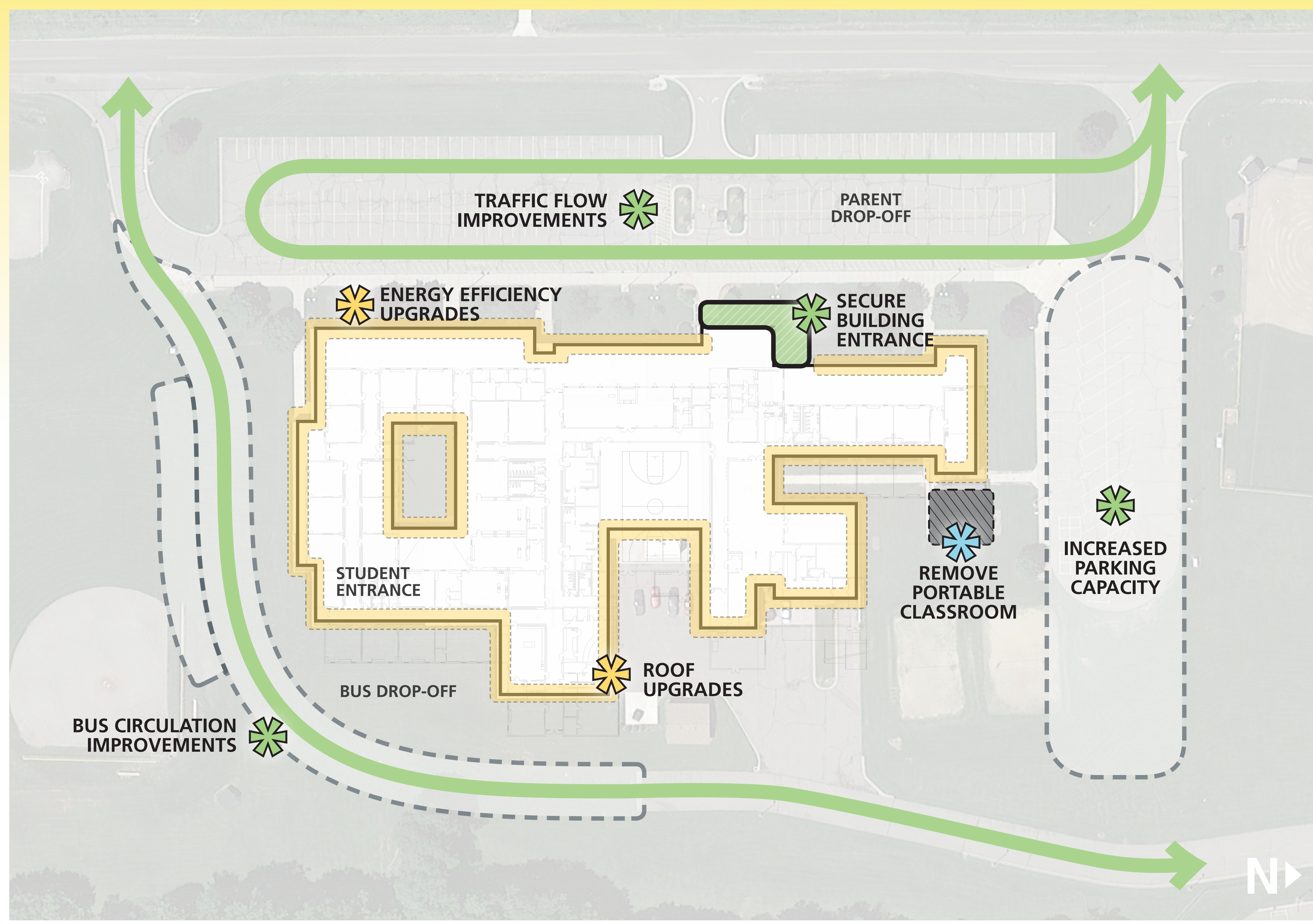

Create **SMARTER** Schools

- Proposal One was developed to create **SMARTER** schools by providing modern learning environments and supporting the district grade restructuring initiative:
- Performing upgrades and renovations to create modern classrooms, including flexible furniture, LED lighting, and integrated technology
 - Upgrading student and staff devices
 - Updating technology infrastructure, including classroom multimedia upgrades, to maximize connectivity, access, and learning

Create **STRONGER** Schools

- Proposal One was developed to create **STRONGER** schools by investing in infrastructure to support district grade restructuring:
- Funding critical upgrades to the mechanical, electrical, and plumbing systems to increase operational efficiencies
 - Replacing roofing as needed
 - Replacing interior finishes as needed

Create **SAFER** Schools

- Proposal One was developed to create **SAFER** schools by upgrading safety measures:
- Providing a secure building entrance and adding video surveillance
 - Updating fire alarm system and exterior lighting
 - Improving traffic flow at drop-offs and pick-ups for pedestrian safety, and improving parking lots and paving

Conceptual site and building diagrams depict potential building and site relationships. Actual layout and design to be determined by school community and staff.



Transition to Beagle Middle School for Grades 7-8

ON NOVEMBER 6, 2018, THE GRAND LEDGE COMMUNITY WILL VOTE ON TWO BOND PROPOSALS.

Proposal One would provide \$118,640,000 for district-wide building and grounds improvements that would address identified and ongoing building issues and would support the district's grade restructuring initiative. Proposal Two would provide \$29,485,000 for athletic and fine arts building and grounds improvements for district and community use.

What Is The District's Grade Restructuring Initiative?

If Proposal One is approved, the grade restructuring made possible by the bond proposal would have many positive effects. Creating K-4th grade elementary schools would mean fewer students in buildings. Kindergarteners would start at their neighborhood elementary school, likely the same one where older siblings attend, and not have to transition elsewhere after their first year. Creating a 5th-6th grade intermediate school would provide flexibility in grouping students for instruction and afford an opportunity for broader curriculum offerings, possibly creating advanced classes along with band and choir. Students would begin to transition away from self-contained, elementary methods of instruction to more departmentalized, secondary-school methods. Transitioning Beagle to a middle school for all 7th-8th grade students would create a secondary school campus with proximity to the high school. Both middle school and high school students could take advantage of the broader curriculum offerings and student services.

Improvements at Beagle would support the district-wide restructuring plan by providing age-appropriate spaces for grades 7-8 and would provide necessary upgrades to the 44 year old building. Improvements at Beagle would be included in the first phase of work.

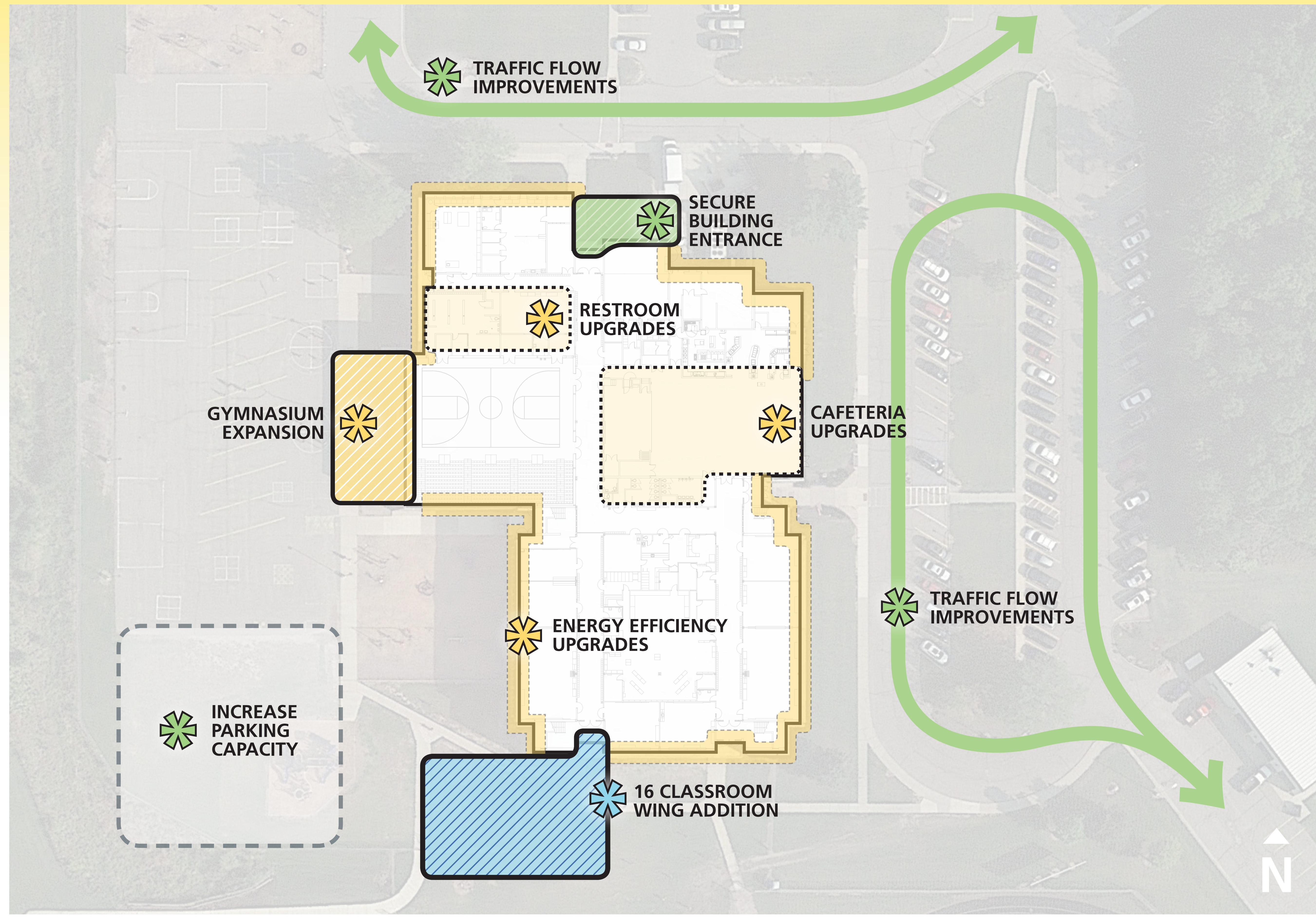

Create **SMARTER** Schools

- Proposal One was developed to create **SMARTER** schools by providing modern learning environments and supporting the district grade restructuring initiative:
- Adding 16 classrooms to support district restructuring
 - Performing upgrades and renovations to create modern classrooms, including flexible furniture, LED lighting, and integrated technology
 - Upgrading student and staff devices
 - Updating technology infrastructure, including classroom multimedia upgrades, to maximize connectivity, access, and learning

Create **STRONGER** Schools

- Proposal One was developed to create **STRONGER** schools by investing in infrastructure to support district grade restructuring:
- Funding critical upgrades to the mechanical, electrical, and plumbing systems to increase operational efficiencies
 - Replacing interior finishes as needed
 - Enlarging the gymnasium
 - Improving the cafeteria and kitchen

Create **SAFER** Schools

- Proposal One was developed to create **SAFER** schools by upgrading safety measures:
- Providing a secure building entrance and adding video surveillance
 - Updating fire alarm and exterior lighting
 - Adding a road connection to M-43 to improve traffic flow
 - Improving traffic flow at drop-offs and pick-ups for pedestrian safety, and improving parking lots and paving

Conceptual site and building diagrams depict potential building and site relationships. Actual layout and design to be determined by school community and staff.



Grand Ledge High School

ON NOVEMBER 6, 2018, THE GRAND LEDGE COMMUNITY WILL VOTE ON TWO BOND PROPOSALS.

Proposal One would provide \$118,640,000 for district-wide building and grounds improvements that would address identified and ongoing building issues and would support the district's grade restructuring initiative. Proposal Two would provide \$29,485,000 for athletic and fine arts building and grounds improvements for district and community use.

What Is The District's Grade Restructuring Initiative?

If Proposal One is approved, the grade restructuring made possible by the bond proposal would have many positive effects. Creating K-4th grade elementary schools would mean fewer students in buildings. Kindergarteners would start at their neighborhood elementary school, likely the same one where older siblings attend, and not have to transition elsewhere after their first year. Creating a 5th-6th grade intermediate school would provide flexibility in grouping students for instruction and afford an opportunity for broader curriculum offerings, possibly creating advanced classes along with band and choir. Students would begin to transition away from self-contained, elementary methods of instruction to more departmentalized, secondary-school methods. Transitioning Beagle to a middle school for all 7th-8th grade students would create a secondary school campus with proximity to the high school. Both middle school and high school students could take advantage of the broader curriculum offerings and student services.

Improvements at the high school would provide necessary upgrades to the 60 year old building and would be included in the third phase of work.

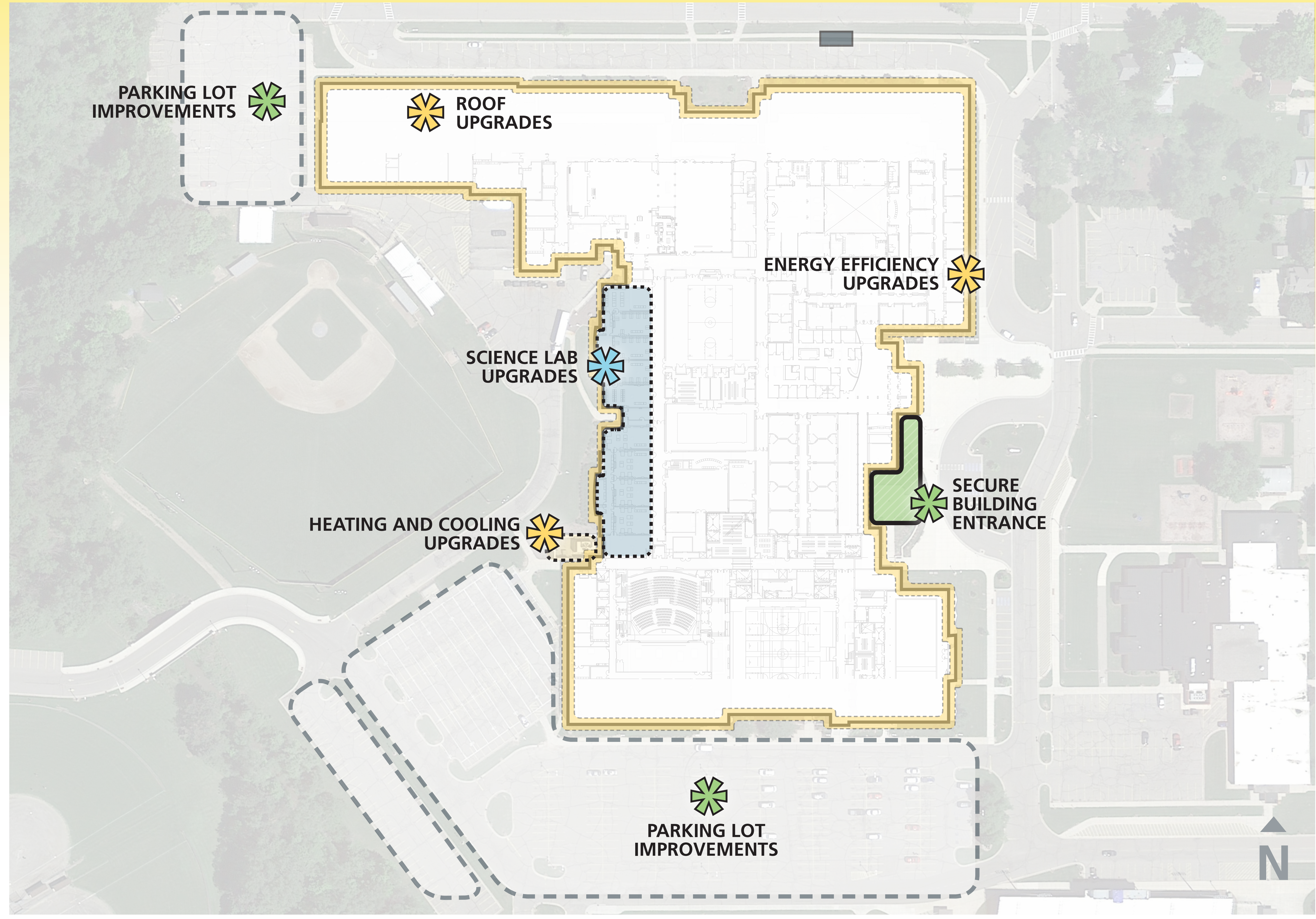

- Proposal One was developed to create **SMARTER** schools by providing modern learning environments and supporting the district grade restructuring initiative:
- Performing upgrades and renovations to create modern classrooms, including flexible furniture, LED lighting, and integrated technology
 - Upgrading student and staff devices
 - Updating technology infrastructure, including classroom multimedia upgrades, to maximize connectivity, access, and learning



- Proposal One was developed to create **STRONGER** schools by investing in infrastructure to support district grade restructuring:
- Funding critical upgrades to the mechanical, electrical, and plumbing systems to increase operational efficiencies
 - Upgrading high school science labs
 - Updating locker rooms
 - Replacing interior finishes as needed



- Proposal One was developed to create **SAFER** schools by upgrading safety measures:
- Providing a secure building entrance and adding video surveillance
 - Updating fire alarm system and exterior lighting
 - Adding a road connection to M-43 to improve traffic flow
 - Improving traffic flow at drop-offs and pick-ups for pedestrian safety, and improving parking lots and paving

Conceptual site and building diagrams depict potential building and site relationships. Actual layout and design to be determined by school community and staff.





PROPOSED BOND ISSUE IMPROVEMENTS

Election Date: Tuesday, November 6, 2018

New Dave and Betty Morris Vocational Building

ON NOVEMBER 6, 2018, THE GRAND LEDGE COMMUNITY WILL VOTE ON TWO BOND PROPOSALS.

Proposal One would provide \$118,640,000 for district-wide building and grounds improvements that would address identified and ongoing building issues and would support the district's grade restructuring initiative. Proposal Two would provide \$29,485,000 for athletic and fine arts building and grounds improvements for district and community use.

What Is The District's Grade Restructuring Initiative?

If Proposal One is approved, the grade restructuring made possible by the bond proposal would have many positive effects. Creating K-4th grade elementary schools would mean fewer students in buildings. Kindergarteners would start at their neighborhood elementary school, likely the same one where older siblings attend, and not have to transition elsewhere after their first year. Creating a 5th-6th grade intermediate school would provide flexibility in grouping students for instruction and afford an opportunity for broader curriculum offerings, possibly creating advanced classes along with band and choir. Students would begin to transition away from self-contained, elementary methods of instruction to more departmentalized, secondary-school methods. Transitioning Beagle to a middle school for all 7th-8th grade students would create a secondary school campus with proximity to the high school. Both middle school and high school students could take advantage of the broader curriculum offerings and student services.

If approved by voters, this bond proposal would provide funding for a new agricultural education center, the Dave and Betty Morris Vocational Building. Construction would be included in the third phase of work.



- Proposal One was developed to create **SMARTER** schools by providing modern learning environments and supporting the district grade restructuring initiative:
- Creating modern classrooms, including flexible furniture, LED lighting, and integrated technology
 - Upgrading student and staff devices



- Proposal One was developed to create **STRONGER** schools by investing in infrastructure to support district grade restructuring:
- Installing up-to-date mechanical, electrical, and plumbing systems to increase operational efficiencies



- Proposal One was developed to create **SAFER** schools by upgrading safety measures:
- Providing a secure building entrance and video surveillance
 - Installing exterior lighting

Conceptual site and building diagrams depict potential building and site relationships. Actual layout and design to be determined by school community and staff.



PROPOSAL TWO - Community, Athletic and Fine Arts Improvements

ON NOVEMBER 6, 2018, THE GRAND LEDGE COMMUNITY WILL VOTE ON TWO BOND PROPOSALS.

Proposal One would provide \$118,640,000 for district-wide building and grounds improvements that would address identified and ongoing building issues and would support the district's grade restructuring initiative. Proposal Two would provide \$29,485,000 for athletic and fine arts building and grounds improvements for district and community use.

Proposal Two was developed for community, athletics and fine arts improvements

- Proposal Two was developed for athletic and fine arts improvements for district and community use
- Improving fine arts spaces at the high school by adding a main lobby and support spaces
 - Constructing a new pool and support spaces at Beagle
 - Remodeling the old pool at the high school for alternative community and athletic uses, including a new community walking track
 - Improving athletic fields and support spaces

