

# BOND UPDATE

October 2020

Building a Better School System for the Community

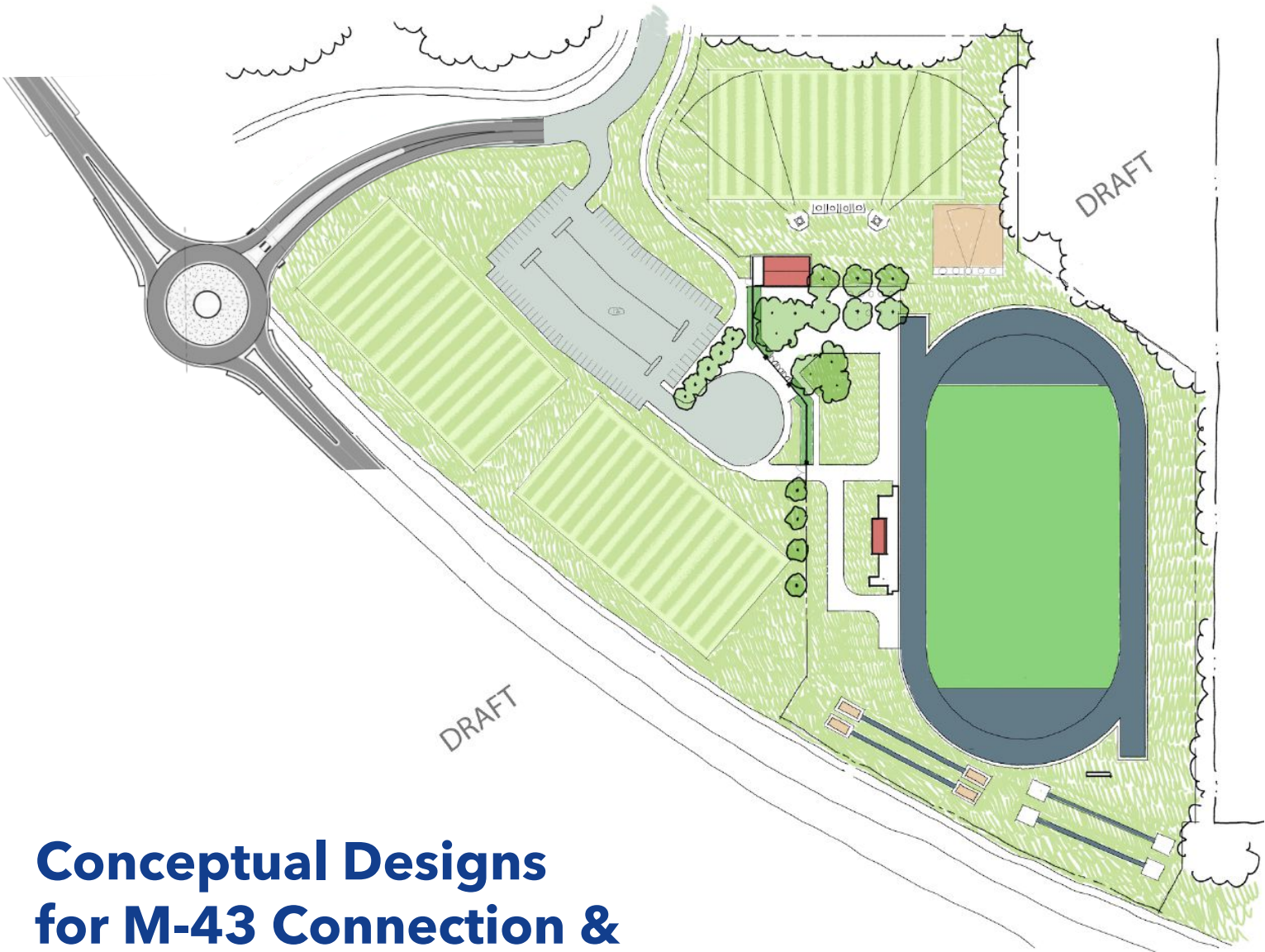

**Conceptual Designs  
for M-43 Connection &  
for New Track & Field Facility**

Phase 1



Phase 1 focuses on Holbrook and Beagle so the district's restructuring initiative can begin in 2021-2022 school year.



Phase 1



### Major Projects for Phase 1

- Transition to Beagle Middle School for Grades 7-8
- Transition to Holbrook Elementary for Grades K-4
- Build New Competition Pool
- Add M-43 Connection

### Why are the bond improvements being completed in three phases?

- Keeps millage rate low
- Maximizes planning time
- Provides adequate time for construction
- Adds technology in all three phases
- Adds buses & transportation improvements in all three phases

Phase 2



### Major Projects for Phase 2

- Build a New Wacousta Elementary for Grades K-4
- Improvements to Delta Center Elementary for Grades K-4
- Fine Arts Improvements and Pool Improvements (to make it the Community Pool) at GLHS
- Add New Track & Field Facility

### Add M-43 Connection

A connecting road will be built from M-43 to our secondary campus of Beagle Middle School and Grand Ledge High School. It will be designed to improve traffic flow as well as help with drop-off and pick-up. Some challenges in building this road are Michigan Department of Transportation bureaucracy, access to a GLPS Operations building, and relocating an athletic facility.

Phase 3



### Major Projects for Phase 2

- New Dave & Betty Morris Building (completed by 2025)
- Improvements to GLHS, Grades 9-12
- Improvements to Hayes Intermediate for Grades 5-6
- Improvements to Willow Ridge Elementary for Grades K-4
- Improvements to Neff Early Childhood Center





The Future Secondary Campus: Beagle Middle School & GLHS

Beagle Middle School



Grand Ledge High School

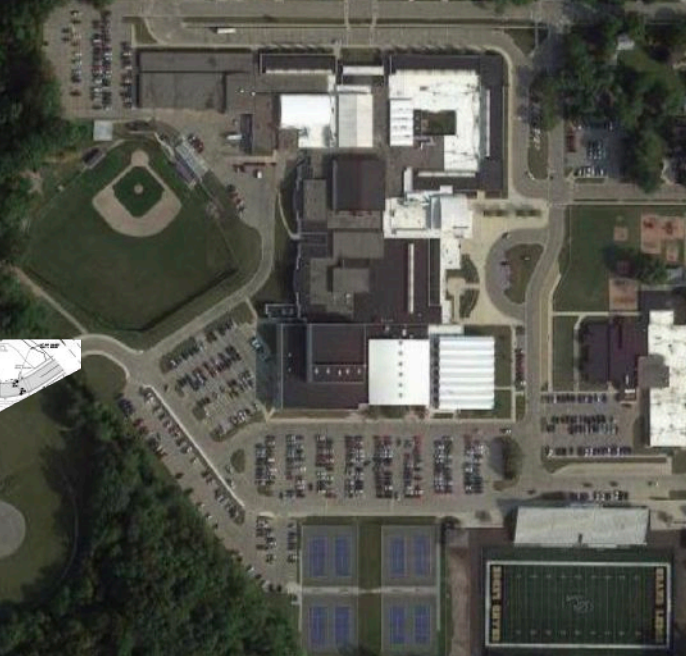

New M-43 Connection



New Track & Field Facility





## New M-43 Connection and New Track & Field Facility

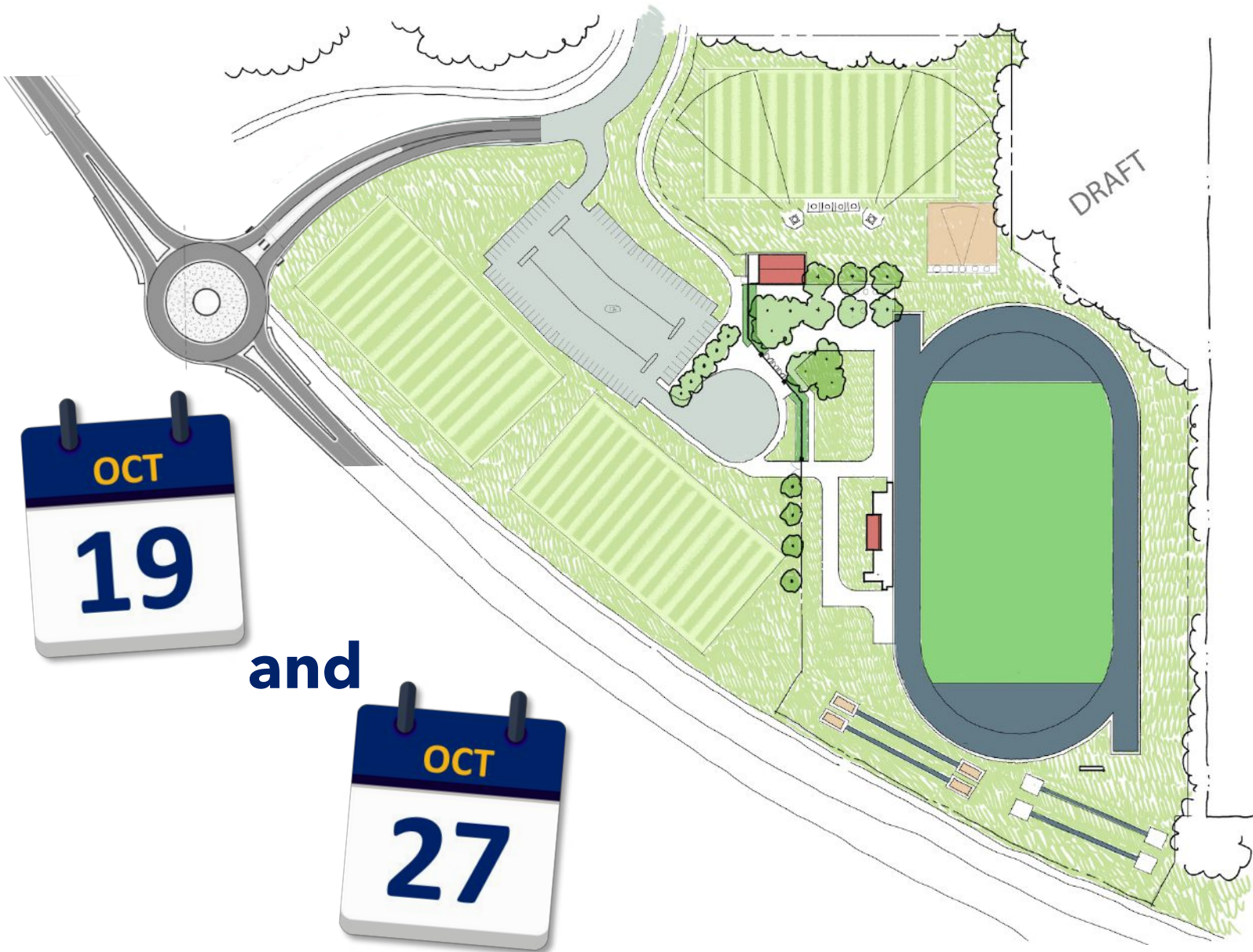

### M-43 Connection Meetings

Three years ago in November 2017, Grand Ledge Public Schools began trying to get access to the “22 acres” from M-43. Since then, Grand Ledge Public Schools has worked with many government agencies to determine what access will be safe and allowed. Grand Ledge Public Schools is holding two virtual meetings – Monday, October 19 & Tuesday, October 27, both starting at 6:00 p.m. – to share information and get feedback about the M-43 connection.

### New Track & Field Facility

The new track and field facility is still in the conceptual design phase, and the plan is to locate it on the “22 acres” along M-43. In the current design, the track itself will be the standard oval shape. Long jump and pole vault will be to the South, throwing events events will be to the North, and high jump will be inside a track curve. The plan is to have the new track and field facility ready for the Spring 2022 season.





## Competition Pool & Diving Well and Band & Choir Rooms

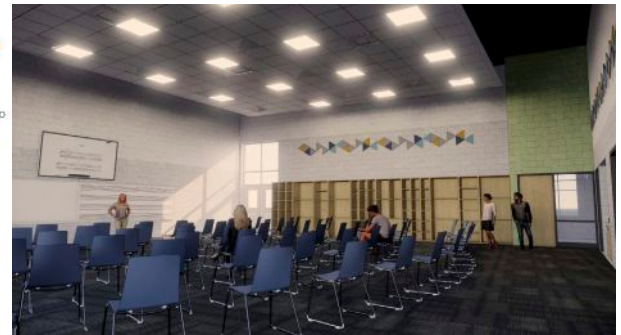

### Band & Choir Rooms

Two specialized music classrooms for band and choir will be added to the Northeast corner of Beagle as a small wing. The music wing will also include four practice rooms and one ensemble room. Storage space is also part of the designs for the music wing.

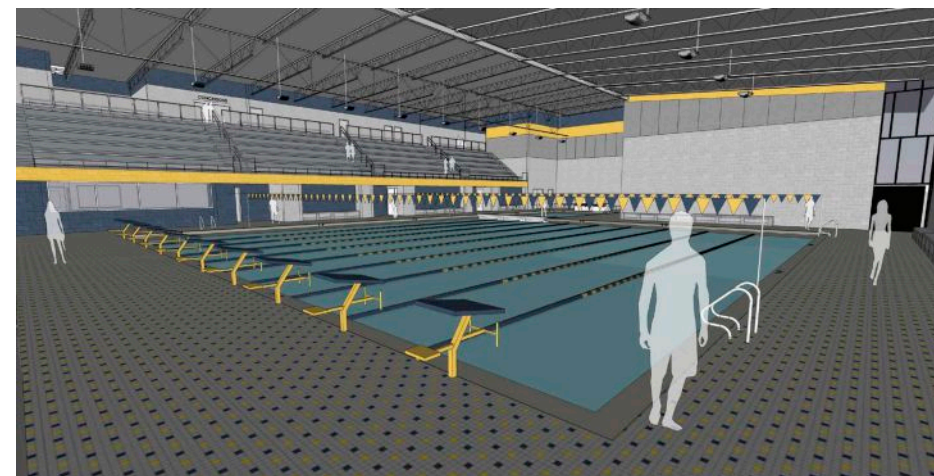

### Competition Pool & Diving Well

Proposal Two plans include a new cold-water competition pool, an additional warm-water community pool, and an indoor walking track. The competition pool is designed to be added to Beagle as shown. There will be improvements made to the pool at Grand Ledge High School, and it will become the warm-water community pool. The walking track is still under development, and the plans will be shared when they are completed.





## The New Holbrook

Hobrook is being redesigned to be a K-4 elementary school to fit with the district's restructuring initiative which is planned to begin in the 2021-2022 school year. The North end of the building will have two floors, with kindergarten classrooms on the first floor and 3<sup>rd</sup> and 4<sup>th</sup> grade classrooms on the second. The existing portion of Holbrook will have 1<sup>st</sup> and 2<sup>nd</sup> grade classrooms. The main entry by the office will be a secure entrance.



A new, bigger parking lot for parents and staff is being built on the Northwest corner of the Holbrook property. It will include better traffic flow for student drop-off and pickup with an entrance and exit on Schoolcraft Street and Jones Street. Busses would not be using this parking lot, and that will improve traffic flow as well.

A bus parking lot is being built to the Southeast of Hobrook. Buses will enter and exit using Green Street, and a gate will be used to keep the lot empty during school. Buses will be able to all be parked at the end of the day to make dismissal simple. The lot will also provide parking space to be used for after-school events (parent-teacher conferences, community use of the new multipurpose gym, etc.).



## Floor Plan for the New Holbrook Elementary School (K-4)

### Second Floor

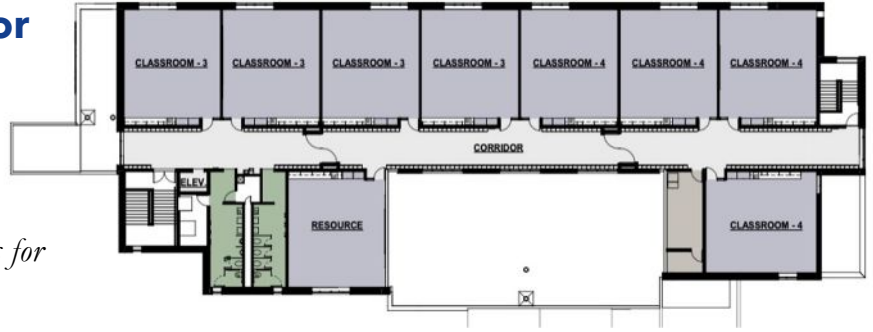

*There will be mechanical and electrical system upgrades for efficiency along with technology infrastructure upgrades.*

### First Floor

#### COLOR KEY

- ASSEMBLY
- CIRCULATION
- CLASSROOM
- EXISTING CLASSROOMS
- KITCHEN
- MECH / ELEC / STORAGE
- OFFICE / ADMIN
- HEALTH
- TOILET



### New Multipurpose Gym

A new multipurpose gym will be added to Holbrook. This will allow physical education classes to happen throughout the day since the space will no longer be required to be used as a cafeteria in the middle of the day. Our growing community recreation program will also be able to use the additional gym for activities it offers.





## The New Beagle

Beagle is being redesigned to be a 7-8 middle school to fit with the district's restructuring initiative which is planned to begin in the 2021-2022 school year. There will be 16 classrooms added to Beagle: a two-story, 14-classroom wing will be added to the Southwest corner of Beagle next to the existing classrooms, and two specialized music classrooms for band and choir will be added to the Northeast corner of Beagle as a small wing.



From Southeast  
Looking Northwest



From East  
Looking West

A new administrative office area will be constructed near the main entry, and the main entry will be updated to create a secure entrance. The kitchen, serving area, and cafeteria will be remodeled. The gym will be enlarged, allowing for increased use for physical education, interscholastic athletics, and community recreation activities.

A new, bigger parking lot for parents and staff is being built on the East side of Beagle, and it has been designed to improve traffic flow for student drop-off and pickup. Buses will drop students off and pick them up on the West side of Beagle, so busses will not be a part of traffic in the parent/staff parking lot.



From Northeast  
Looking Southwest



## Updated Floor Plan for the New Beagle Middle School (7-8)

### News about the Pools

Proposal Two plans include a new cold-water competition pool, an additional warm-water community pool, and an indoor walking track. The competition pool is designed to be added to Beagle as shown. There will be improvements made to the pool at Grand Ledge High School, and it will become the warm-water community pool. The walking track is still under development, and the plans will be shared when they are completed.

### COLOR KEY

- ASSEMBLY
- CIRCULATION
- CLASSROOM
- GYM/POOL
- KITCHEN/ SERVERY
- MECH / ELEC / STORAGE
- OFFICE / ADMIN
- TBD 1
- TOILET

### Addition to Second Floor



**First Floor**

*There will be mechanical and electrical system upgrades for efficiency along with technology infrastructure upgrades.*







PROPOSAL 1 – SCHOOL IMPROVEMENTS



PROPOSAL 2 – COMMUNITY, ATHLETICS, & FINE ARTS IMPROVEMENTS



## GLPS Debt Millage Rate Still 3<sup>rd</sup> Lowest in the CAAC!

Even after the community passed both bond proposals on November 6, 2018, Grand Ledge Public Schools still has the 3<sup>rd</sup> lowest debt tax millage rate in the Capital Area Activities Conference (CAAC). Grand Ledge Public Schools is very fiscally responsible with the tax-payers' money and provides a great value as we educate our community's children.

*Source: Michigan Department of Treasury's "School District & ISD - 2019 PPT Calculations by Millage (updated May 2020)" file.*

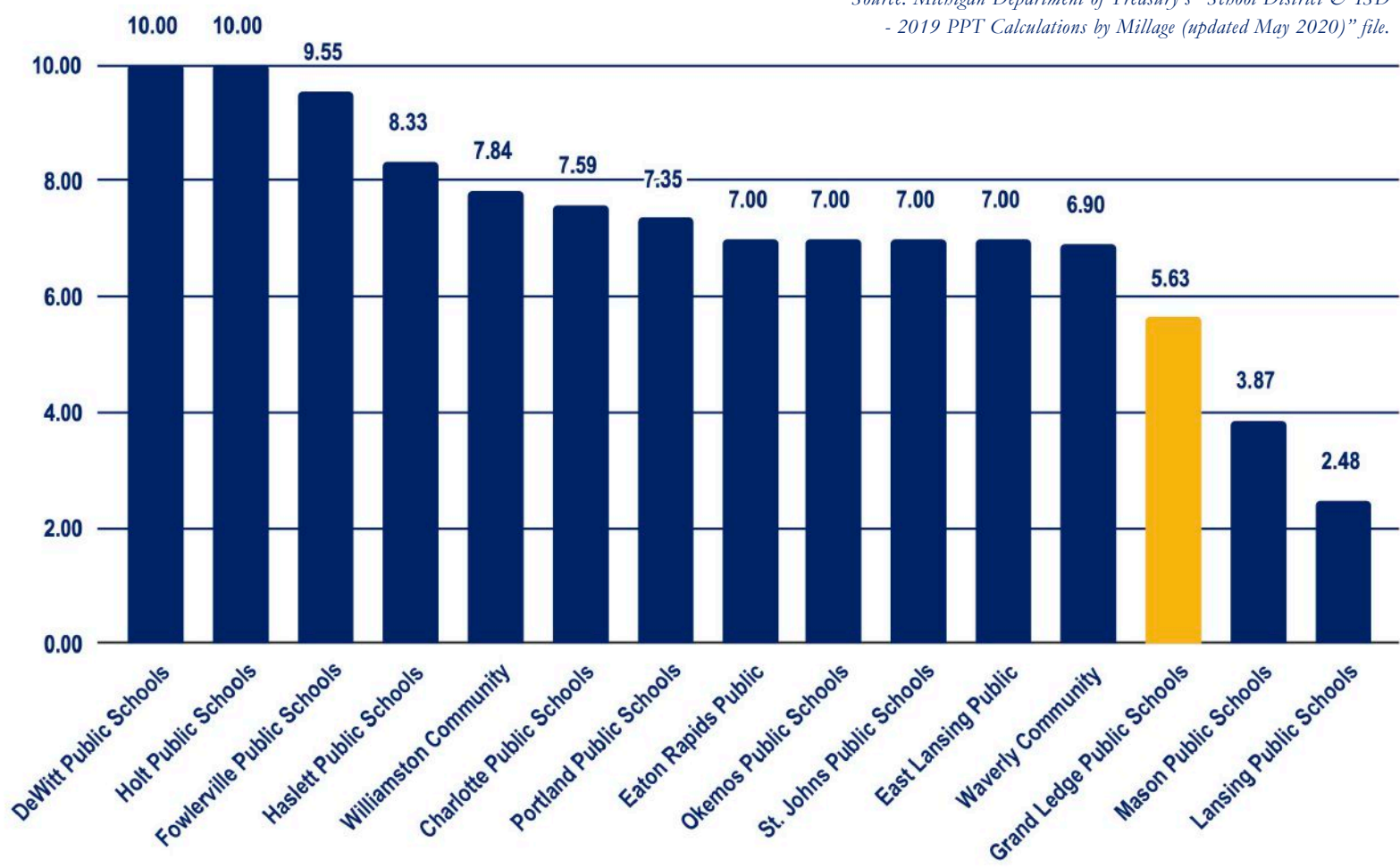

### For More Information...

Contact Mr. John Ellsworth, Director of Communications, at 517-925-5414 or EllsworthJ@GLcomets.net or visit [GLcomets.net /Bonds](http://GLcomets.net/Bonds)

